

Proposed Renewal of Richmond Green Branch

Richmond Green Branch is currently co-located with Richmond Green Secondary School. It provides service to much of the eastern side of Richmond Hill.

In the short term, the experience of the branch will be much improved by **greening the entry plaza** between the existing library and the high school, and providing **outdoor areas** for programming and passive enjoyment.

Enhanced signage, streamlined vehicle access, and a **new front door** will better identify the branch and distinguish it from the school.

As Richmond Hill's eastern neighbourhoods are growing, this Facilities Master Plan will evaluate if renovating the existing branch over constructing a new, dedicated branch in the area will better suit the local population.

Proposed Site Plan

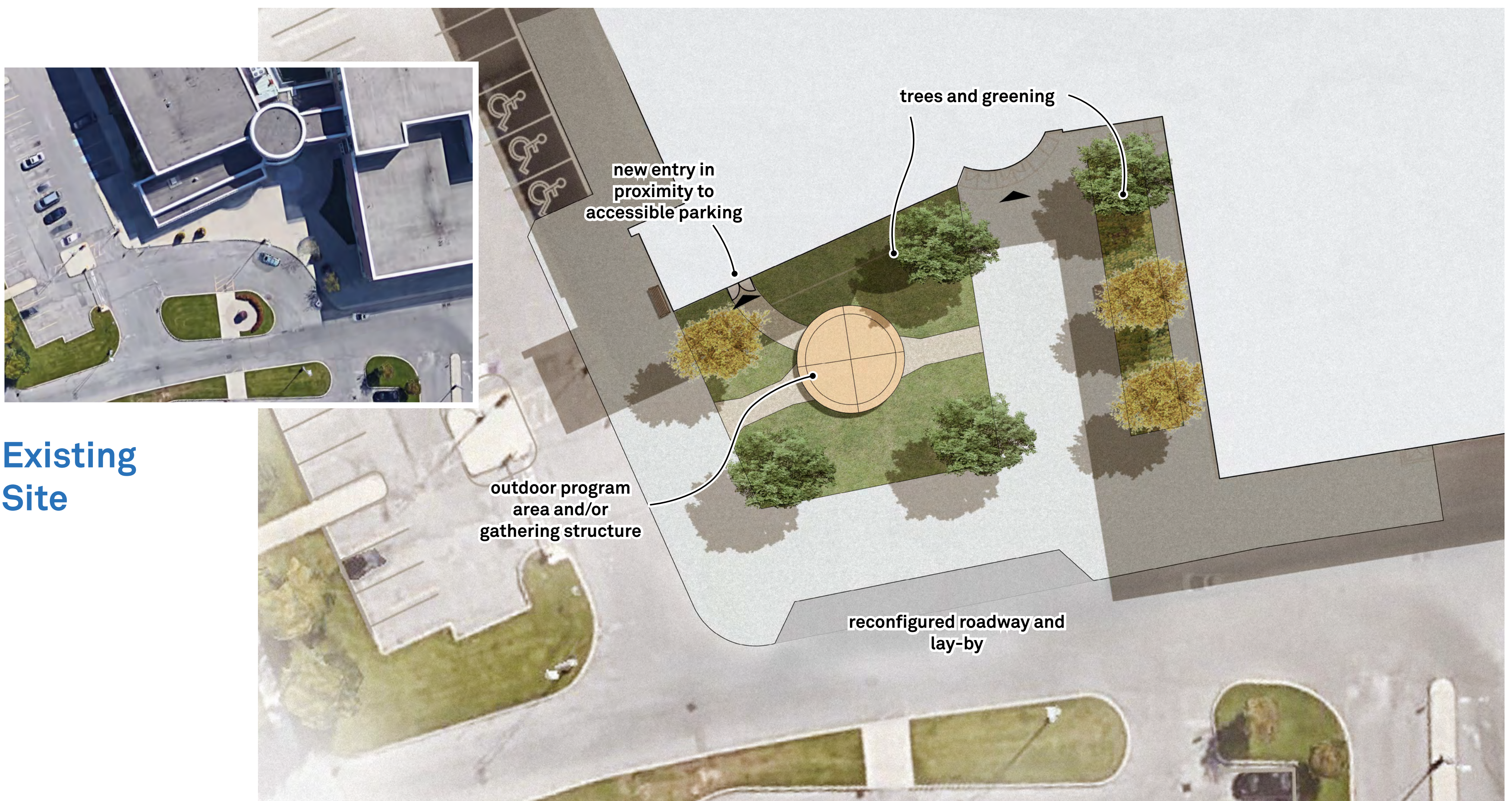

Existing Site

Relocated Entryway



A new, distinct entryway for the library will help reinforce the presence of the public library as a separate space from the high school. Locating the entry closer to accessible parking and in proximity to new green spaces will improve the user experience.

Trees and Greening



Increased permeable surface, trees, and greening will improve the image of the library and create a more welcoming outdoor space. These changes can offer educational opportunities around plants, water, and sustainability.

Outdoor Program Areas



Outdoor program areas and outdoor classrooms would be a valuable resource both for the branch and the school. This can offer opportunities for children's programming for the library, as well as an outdoor reading room for passive enjoyment.

Gathering Structure



A gathering structure can be co-located with outdoor program areas to create a wayfinding feature and focal point, designed and programmed in consultation with Richmond Hill's Indigenous community.